

**AMBIENTE OVERPLATE SECTION. Tiled Floor Finish**

**TITLE**  
OVERPLATE SECTION - Tiled Floor Finish

**CAD FILE**  
20250305-OVERPLATE SECTION-DET SECTIONS.DWG

**DRAWN**  
VL

**CHECKED**  
GC

**DATE**  
05.03.2025

**SCALE**  
N/A



AMBIENTE SYSTEMS LIMITED  
 HERITAGE HOUSE, UNIT 1 WOODSIDE LANE, BELL BAR, HERTFORDSHIRE, AL9 6DE  
 SALES@AMBIENTEUFH.CO.UK  
 T.01707 649 118

THIS FILE AND ITS CONTENT ARE THE PROPERTY OF AMBIENTE SYSTEMS LIMITED AND ARE PROTECTED BY COPYRIGHT LAWS. THIS FILE AND ITS CONTENTS MAY ONLY BE DISTRIBUTED, COPIED OR REPRODUCED IN FULL AND MAY NOT BE EDITED OR COPIED IN PART. DO NOT SCALE FROM THIS DRAWING.

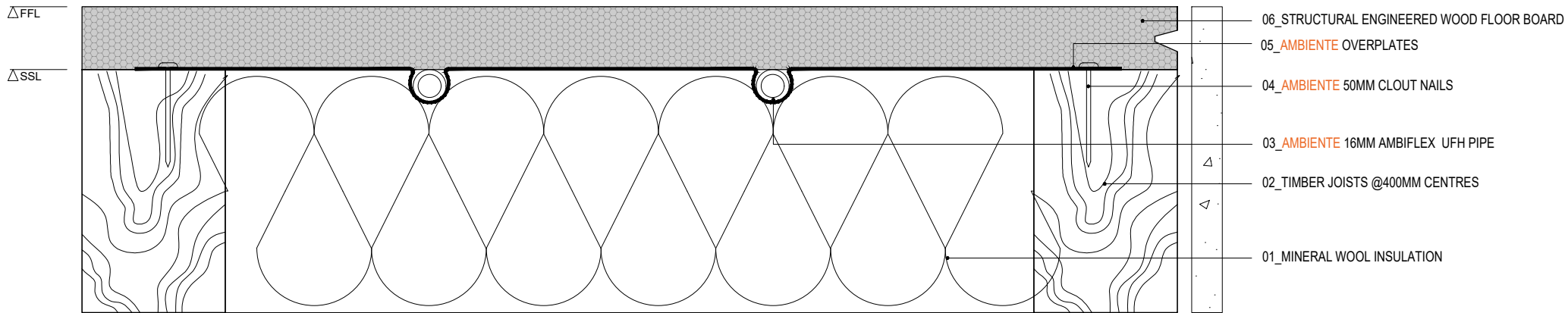

**AMBIENTE OVERPLATE SECTION. Structural Wood Floor Board Finish**

<b>TITLE</b> OVERPLATE SECTION - Structural Wood Floor Board Finish		<b>CAD FILE</b> 20250305-OVERPLATE SECTION-DET SECTIONS.DWG	
<b>DRAWN</b> VL	<b>CHECKED</b> GC	<b>DATE</b> 05.03.2025	<b>SCALE</b> N/A



AMBIENTE SYSTEMS LIMITED  
 HERITAGE HOUSE, UNIT 1 WOODSIDE LANE, BELL BAR, HERTFORDSHIRE, AL9 6DE  
 SALES@AMBIENTEUFH.CO.UK  
 T.01707 649 118

THIS FILE AND ITS CONTENT ARE THE PROPERTY OF AMBIENTE SYSTEMS LIMITED AND ARE PROTECTED BY COPYRIGHT LAWS. THIS FILE AND ITS CONTENTS MAY ONLY BE DISTRIBUTED, COPIED OR REPRODUCED IN FULL AND MAY NOT BE EDITED OR COPIED IN PART.  
 DO NOT SCALE FROM THIS DRAWING.

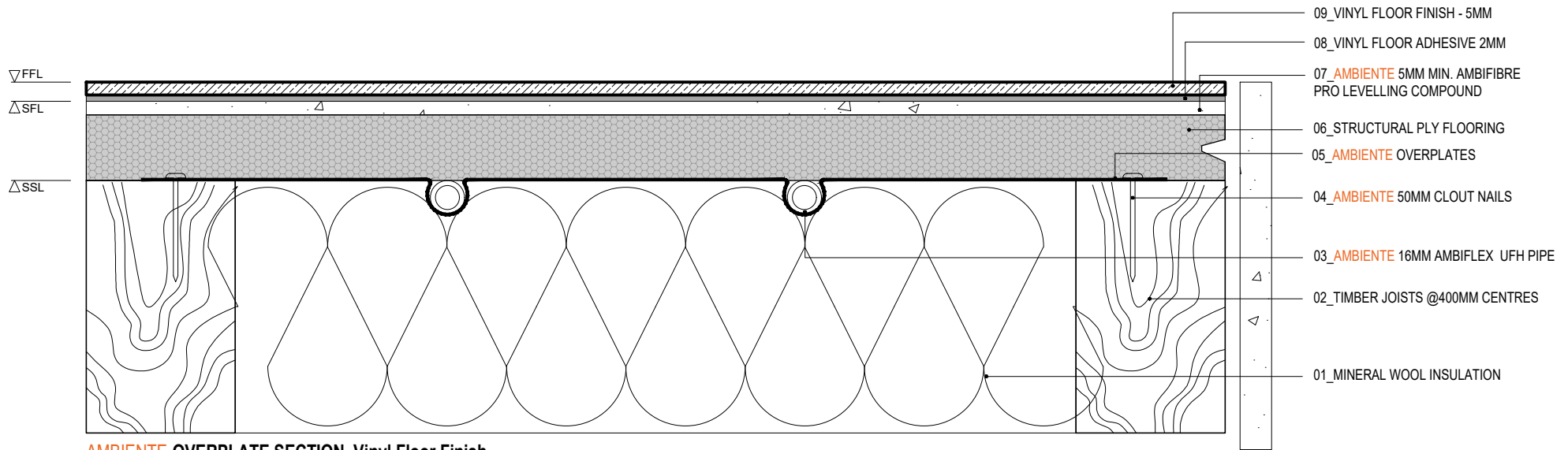

**AMBIENTE OVERPLATE SECTION. Vinyl Floor Finish**

<b>TITLE</b> OVERPLATE SECTION - Vinyl Floor Finish		<b>CAD FILE</b> 20250305-OVERPLATE SECTION-DET SECTIONS.DWG	
<b>DRAWN</b> VL	<b>CHECKED</b> GC	<b>DATE</b> 05.03.2025	<b>SCALE</b> N/A



AMBIENTE SYSTEMS LIMITED  
 HERITAGE HOUSE, UNIT 1 WOODSIDE LANE, BELL BAR, HERTFORDSHIRE, AL9 6DE  
 SALES@AMBIENTEUFH.CO.UK  
 T.01707 649 118

THIS FILE AND ITS CONTENT ARE THE PROPERTY OF AMBIENTE SYSTEMS LIMITED AND ARE PROTECTED BY COPYRIGHT LAWS. THIS FILE AND ITS CONTENTS MAY ONLY BE DISTRIBUTED, COPIED OR REPRODUCED IN FULL AND MAY NOT BE EDITED OR COPIED IN PART.  
 DO NOT SCALE FROM THIS DRAWING.

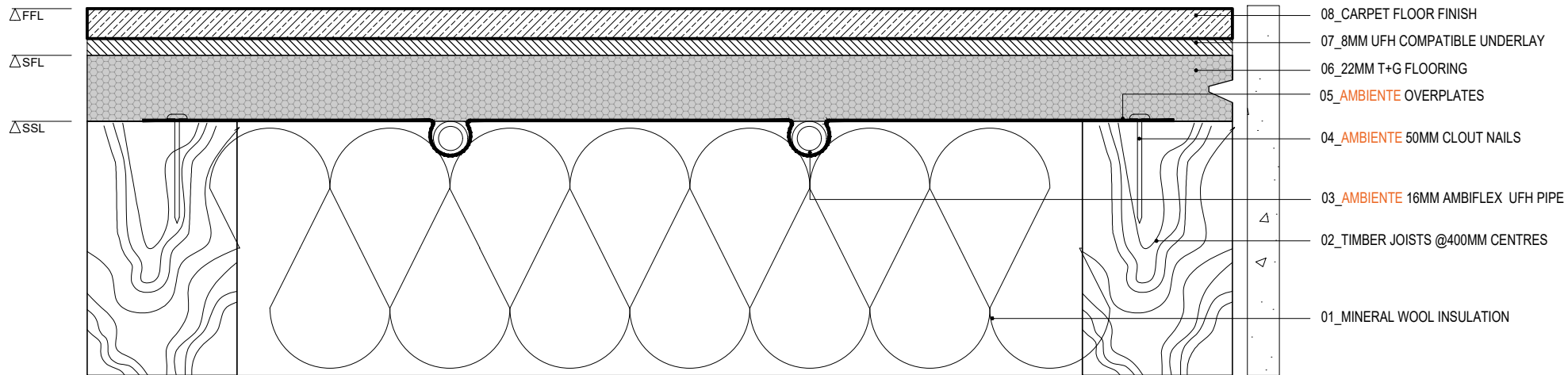

**AMBIENTE OVERPLATE SECTION. Carpet Floor Finish**

**TITLE**  
OVERPLATE SECTION - Carpet Floor Finish

**CAD FILE**  
20250305-OVERPLATE SECTION-DET SECTIONS.DWG

**DRAWN**  
VL

**CHECKED**  
GC

**DATE**  
05.03.2025

**SCALE**  
N/A



AMBIENTE SYSTEMS LIMITED  
 HERITAGE HOUSE, UNIT 1 WOODSIDE LANE, BELL BAR, HERTFORDSHIRE, AL9 6DE  
 SALES@AMBIENTEUFH.CO.UK  
 T.01707 649 118

THIS FILE AND ITS CONTENT ARE THE PROPERTY OF AMBIENTE SYSTEMS LIMITED AND ARE PROTECTED BY COPYRIGHT LAWS. THIS FILE AND ITS CONTENTS MAY ONLY BE DISTRIBUTED, COPIED OR REPRODUCED IN FULL AND MAY NOT BE EDITED OR COPIED IN PART. DO NOT SCALE FROM THIS DRAWING.